

SOLAR ENERGY FACILITY LOCATED NORTHEAST OF MOUNT FOREST. PLANS INCLUDE VISUAL SCREENING MITIGATION PLANTINGS, PLANTING DETAILS AND SPECIES LISTS.

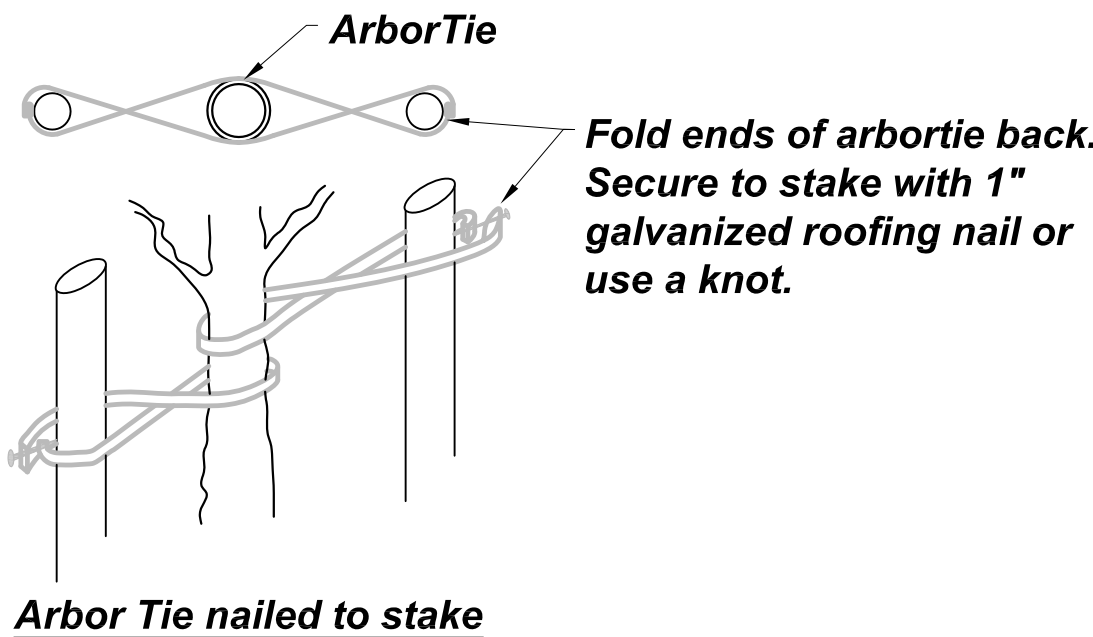

DRAFT
NOT FOR CONSTRUCTION

										DESIGN JL	REVIEWED BY CP	SOUTHGATE SOLAR LP	PROJECT NO. 14-9154	
										DRAWN JL	CHECKED BY CP		LANDSCAPE SCREENING KEY PLAN	SHEET NO. L0
										DATE June 2015				
										SCALE NTS				
1	Submitted to Client for Review						06-11-15	JL						
No.	ISSUED FOR _____						JATF	JY						

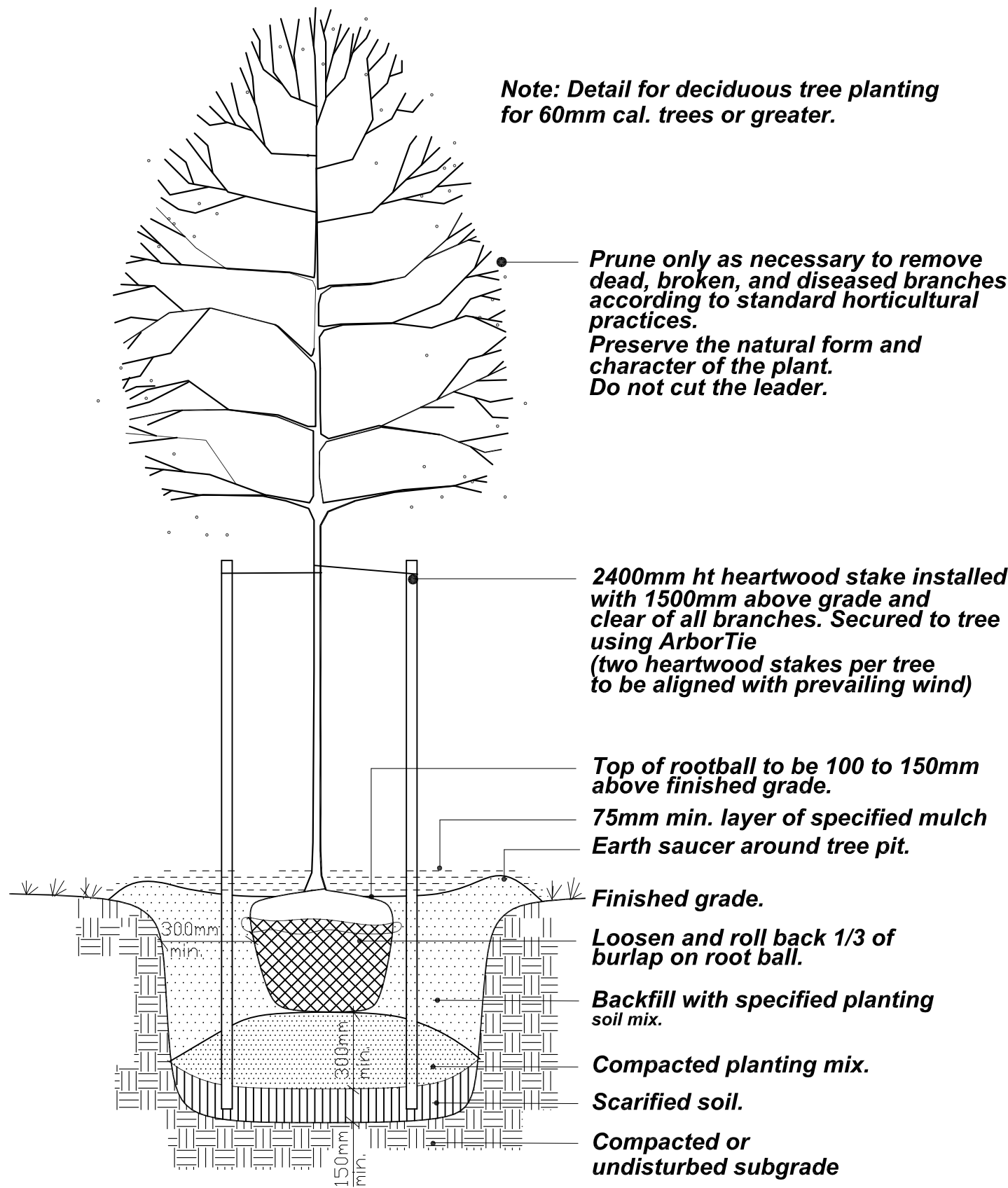

Materials:
-Specified ArborTie green (or white) staking and guying material is to be flat woven polypropylene material. 3/4" (19.05 mm) wide 900 lb. break strength.
-ArborTie shall be fastened to stakes in a manner which permits tree movement and supports the tree.

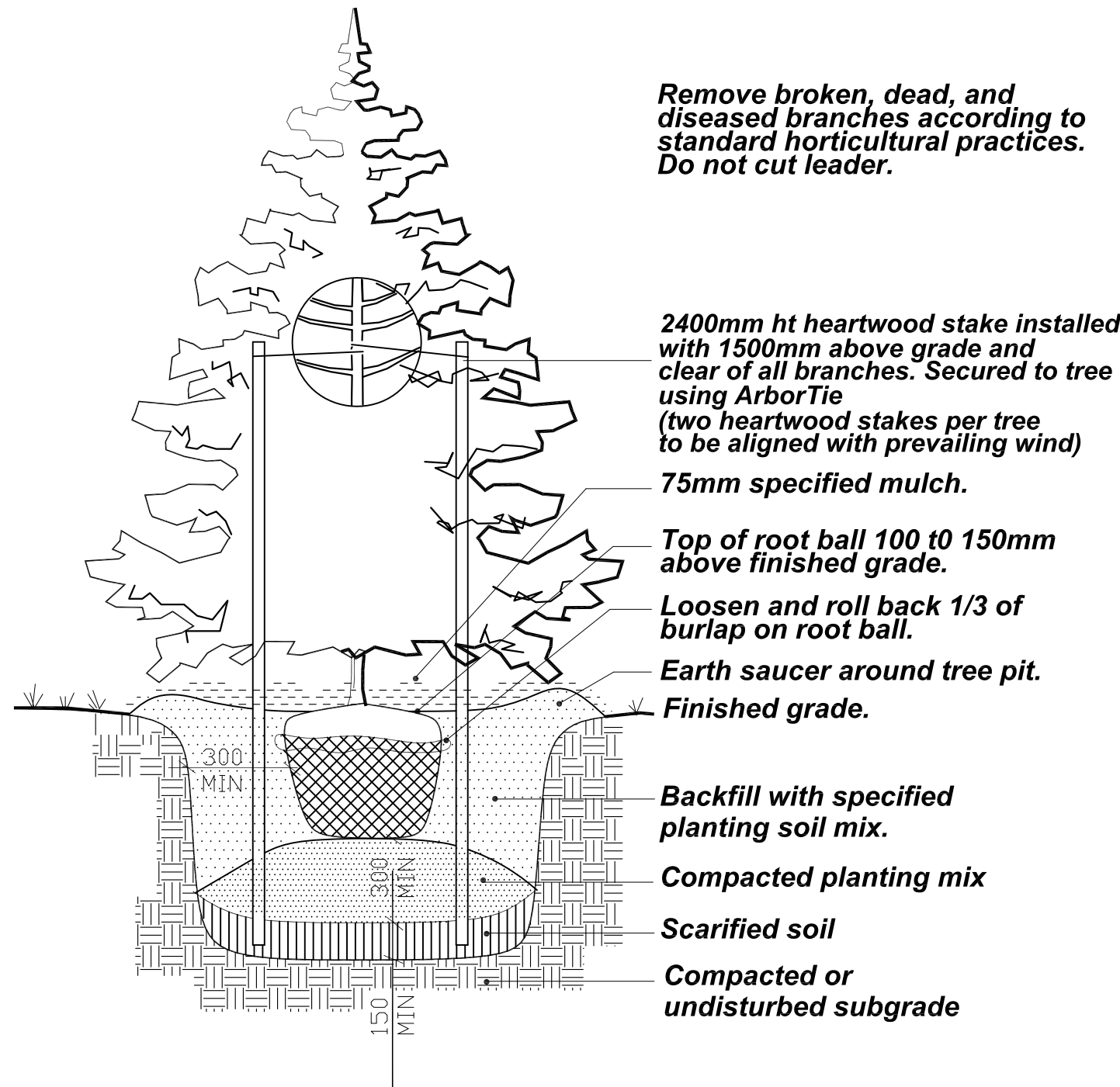

TYPICAL PLANTING NOTES:

1. NO SPECIES SUBSTITUTION WITHOUT WRITTEN AUTHORIZATION FROM THE LANDSCAPE ARCHITECT.
2. ENSURE THAT PLANT MATERIAL DOES NOT DRY OUT PRIOR TO INSTALLATION.
3. TREES SHALL BE SET @ 50mm ABOVE ORIGINAL NURSERY GRADE AND SURROUNDING GRADE TO ALLOW FOR SETTLEMENT.
4. DO NOT ALLOW AIR POCKETS WHEN BACKFILLING.
5. MULCH AND WATER PLANT IMMEDIATELY FOLLOWING PLANTING.
6. CONTRACTOR SHALL REMOVE TREE STAKES AND TIES ONE YEAR AFTER PLANTING, OR AT END OF WARRANTY PERIOD IF STAKES ARE STILL REQUIRED.
7. NO TREE PITS SHALL BE LEFT OPEN OVERNIGHT.
8. PLANT MATERIAL SHALL NOT SIT ON SITE FOR LONGER THAN 5 DAYS.
9. DISTURBED SOIL AREAS TO BE SEEDED WITH SPECIFIED SEED MIX. CONTRACTOR TO USE 100% ELYMUS CANADENSIS (CANADA WILD RYE) AS A COVER CROP. SEEDING TO BE IN ACCORDANCE WITH OPSS 572.
10. TOPSOIL TO BE SUPPLIED AND INSTALLED ACCORDING TO OPSS 570 TO A MINIMUM DEPTH OF 150mm UNLESS OTHERWISE SPECIFIED.
11. DISTURBED SOIL AREAS TO BE COVERED WITH MINIMUM 75mm SHREDDED MULCH SUCH AS GRO-BARK SPM OR HARDWOOD BLEND OR APPROVED EQUIVALENT. ALTERNATIVE MULCH TO BE APPROVED BY LANDSCAPE ARCHITECT IN WRITING.
12. PLANTING ON 3:1 SLOPE, CREATE TEMPORARY 100MM HIGH SOIL MIX BERM ON DOWNHILL SIDE OF PLANTING PIT TO RETAIN WATER. ENSURE THAT PLANT MATERIAL DOES NOT DRY OUT PRIOR TO INSTALLATION.

TYPICAL NOTES:

1. ALL WORK TO BE CARRIED OUT IN ACCORDANCE WITH BY-LAWS AND CODES HAVING JURISDICTION OVER SITE LOCATION.
2. THE CONTRACTOR SHALL MAKE EVERY EFFORT TO PRESERVE MATURE TREES WHICH ARE BEYOND THE CONSTRUCTION LIMITS.
3. ANY CHANGES OR SUBSTITUTIONS TO THE PLANT MATERIAL MUST BE APPROVED BY THE LANDSCAPE ARCHITECT.
4. CLEARING AND GRUBBING SHALL BE UNDERTAKEN AS TO MINIMIZE DISRUPTION TO ADJACENT LANDS NOT WITHIN THE CONSTRUCTION LIMITS. ENCROACHMENT ON WOODLANDS NOT INDICATED ON THE DRAWINGS WILL REQUIRE WRITTEN CONSENT BY THE LAND OWNER AND CONSERVATION AUTHORITY.
5. IT IS THE RESPONSIBILITY OF THE CLIENT AND THEIR SELECTED CONTRACTOR TO CONFIRM THE ACCURACY OF THE SETBACKS, LOCATIONS AND GRADES, ETC. ANY VARIATIONS BETWEEN EXISTING CONDITIONS AND THE PLAN SHOULD BE ADJUSTED ON SITE AND REPORTED TO THE LANDSCAPE CONSULTANT TO DETERMINE THE IMPACT OF THE VARIATIONS ON THE STABILITY OF THE PROPOSED PLANTING.
6. IT IS THE RESPONSIBILITY OF THE CLIENT AND THEIR SELECTED CONTRACTOR TO CONFIRM THE LOCATIONS OF ALL UTILITIES, BOTH ABOVE AND BELOW GROUND. ANY UTILITIES ON SITE FOUND TO CONFLICT WITH THE PLAN SHOULD BE REPORTED TO THE LANDSCAPE CONSULTANT TO DETERMINE WHERE ADJUSTMENTS TO THE PLANTINGS ARE REQUIRED.
7. CONTRACTOR TO PROVIDE A MINIMUM TWO (2) YEAR WARRANTY FROM DATE ACCEPTED ON ALL WORK.
8. CONTRACTORS ARE NOT TO SCALE MEASUREMENTS OFF OF THE DRAWING.
9. LANDSCAPE PLAN IS DRAFT UNTIL APPROVED BY THE LOCAL MUNICIPALITY.

DRAFT
NOT FOR CONSTRUCTION

D1 DECIDUOUS TREE PLANTING

N.T.S.

D2 CONIFEROUS TREE PLANTING

N.T.S.

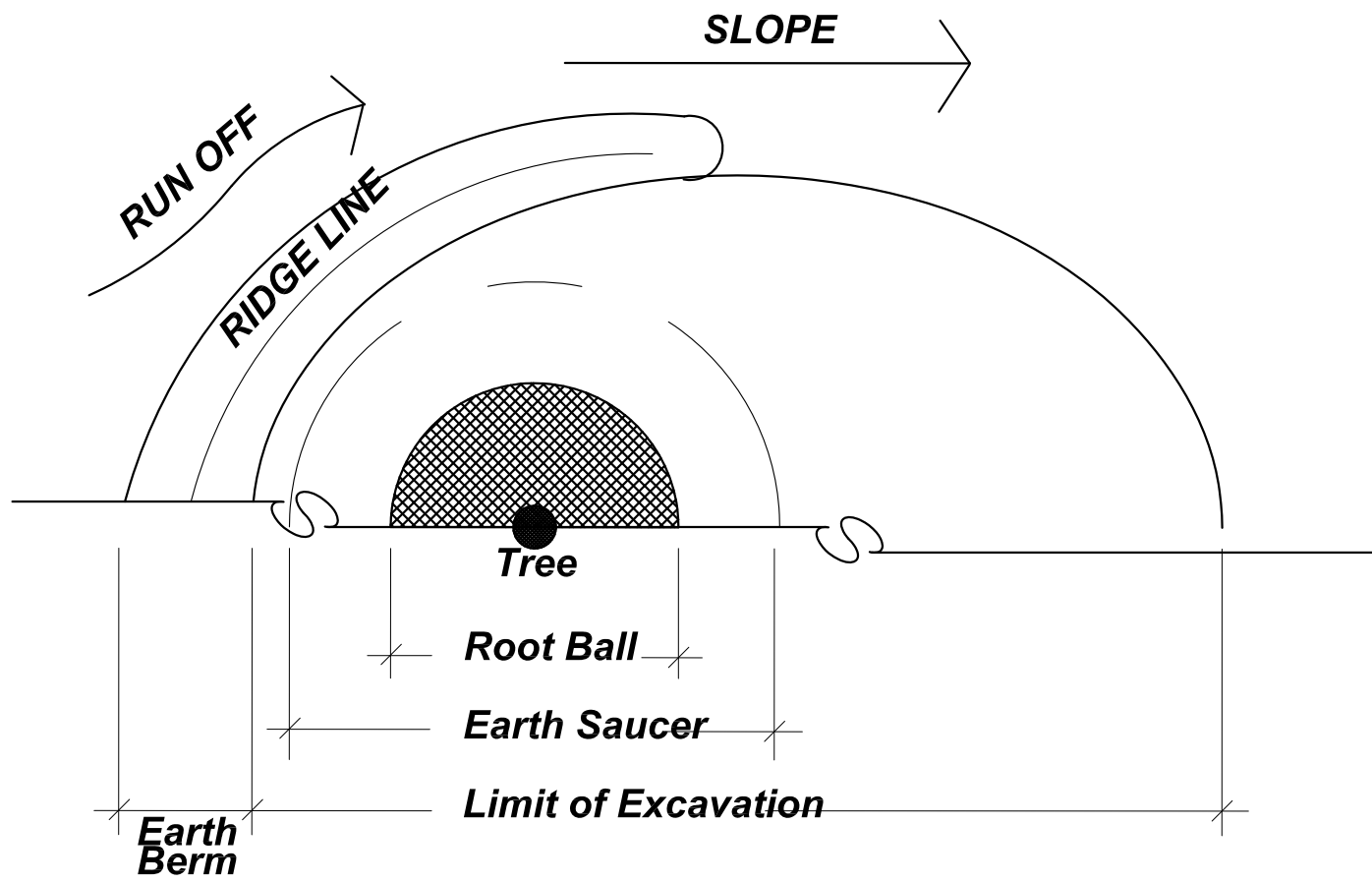
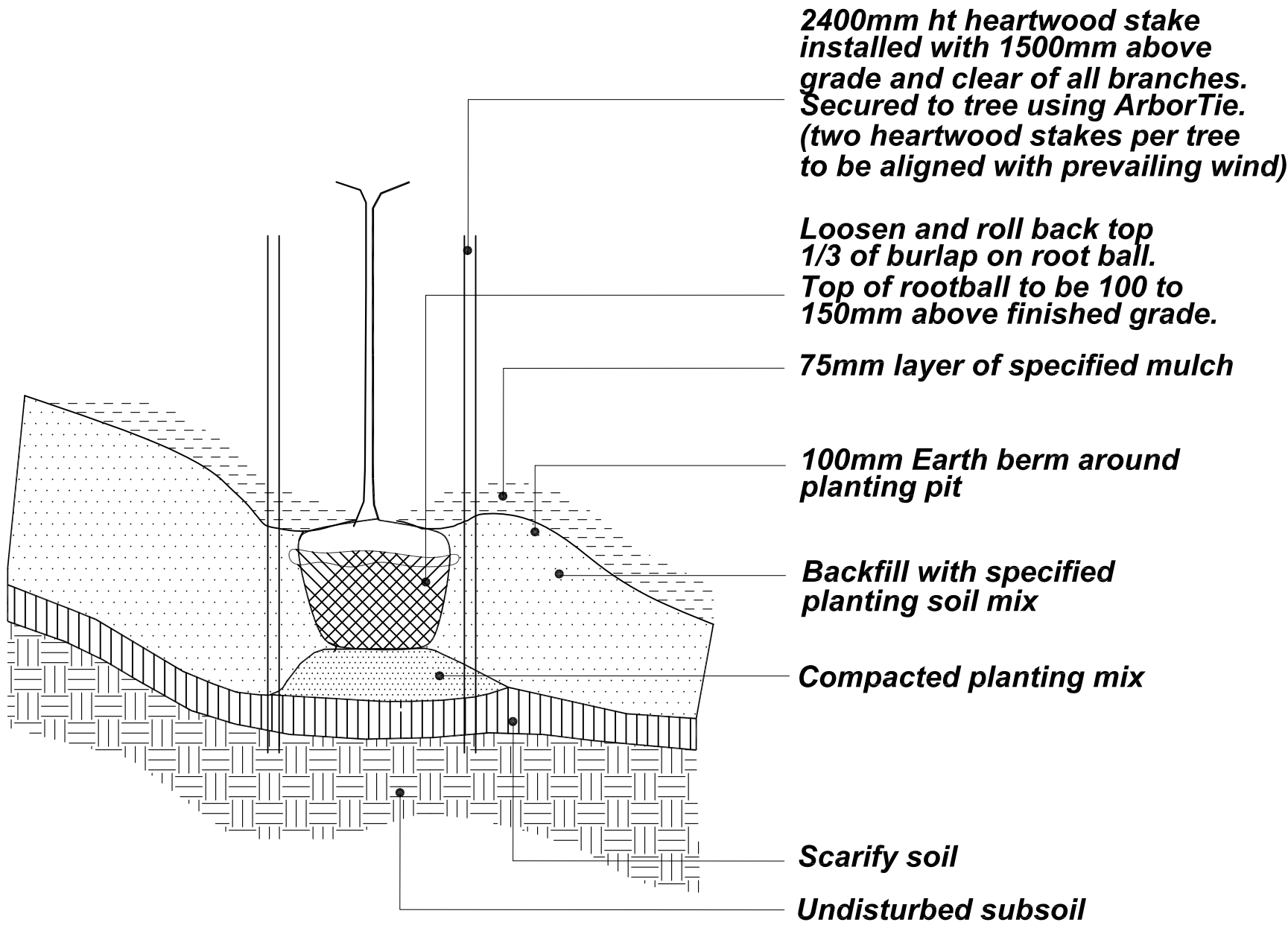
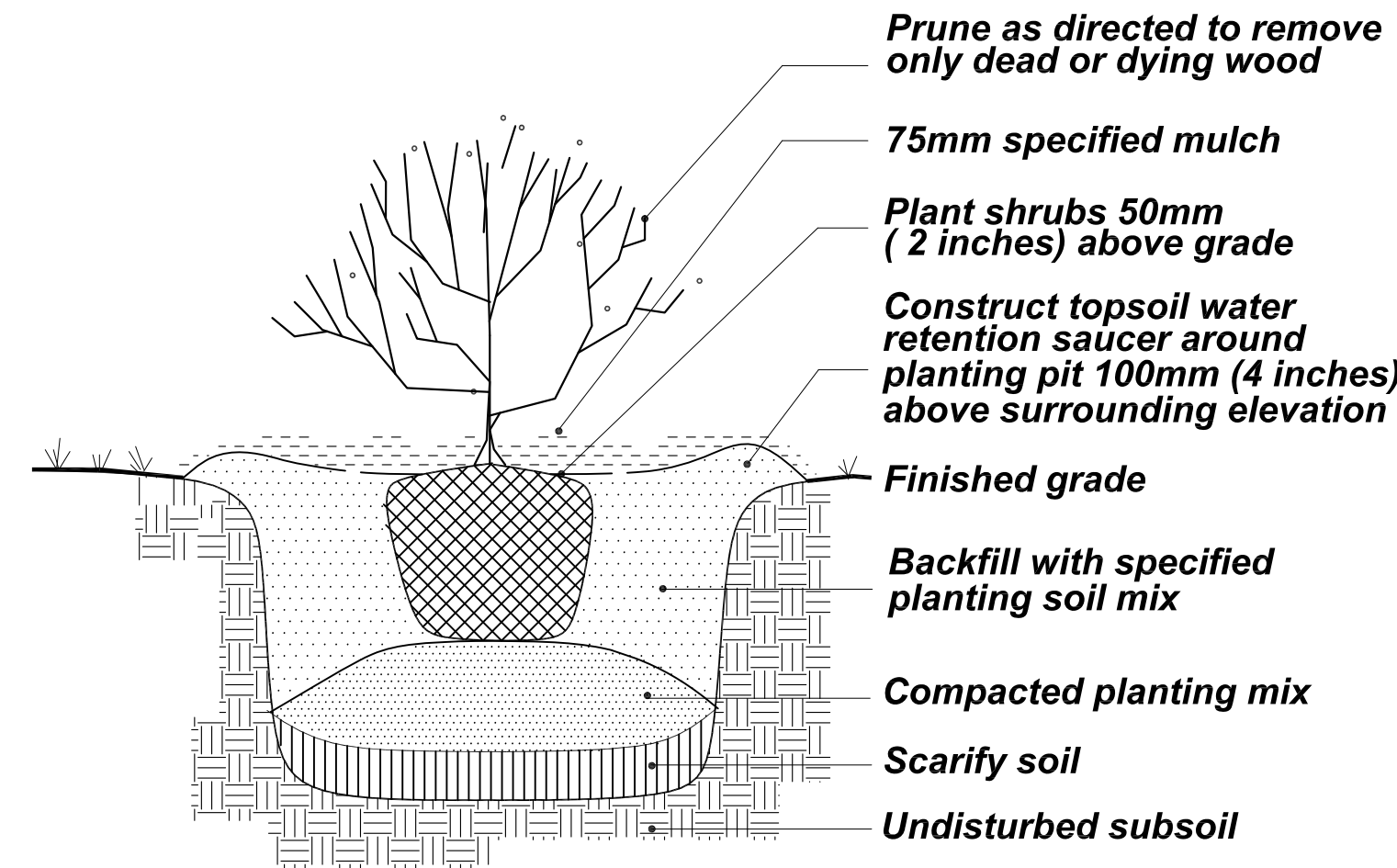

D4 SHRUB PLANTING

N.T.S.

D3 SLOPE PLANTING

N.T.S.

Conditions of Use

Verify elevations and/or dimensions on drawing prior to use.
Report any discrepancies to Dillon Consulting Limited.

Do not scale dimensions from drawing.

Do not modify drawing, re-use it, or use it for purposes other than those intended at the time of its preparation without prior written permission from Dillon Consulting Limited.



DESIGN	JL	REVIEWED BY	CP
DRAWN	JL	CHECKED BY	CP
DATE	June 2015		
SCALE	NTS		
1	Submitted to Client for Review	06-11-15	JL
No.	ISSUED FOR	DATE	BY

SOUTHGATE SOLAR LP

PROJECT NO.
14-9154

LANDSCAPE SCREENING
PLANTING DETAILS

SHEET NO.
L8

FILENAME: C:\USERS\JL\DESKTOP\ON-GOING WORK\14-9154 SAMBUNG SOLAR\AS WORKING\CAO\14-9154 LANDSCAPE PLAN 04-16-2015 V4.DWG PLOTTED BY: LEASA, JAY
PLOT DATE: 2015-06-11 09:13:20 PLOT SCALE: 1:1 PLOT STYLE: -----

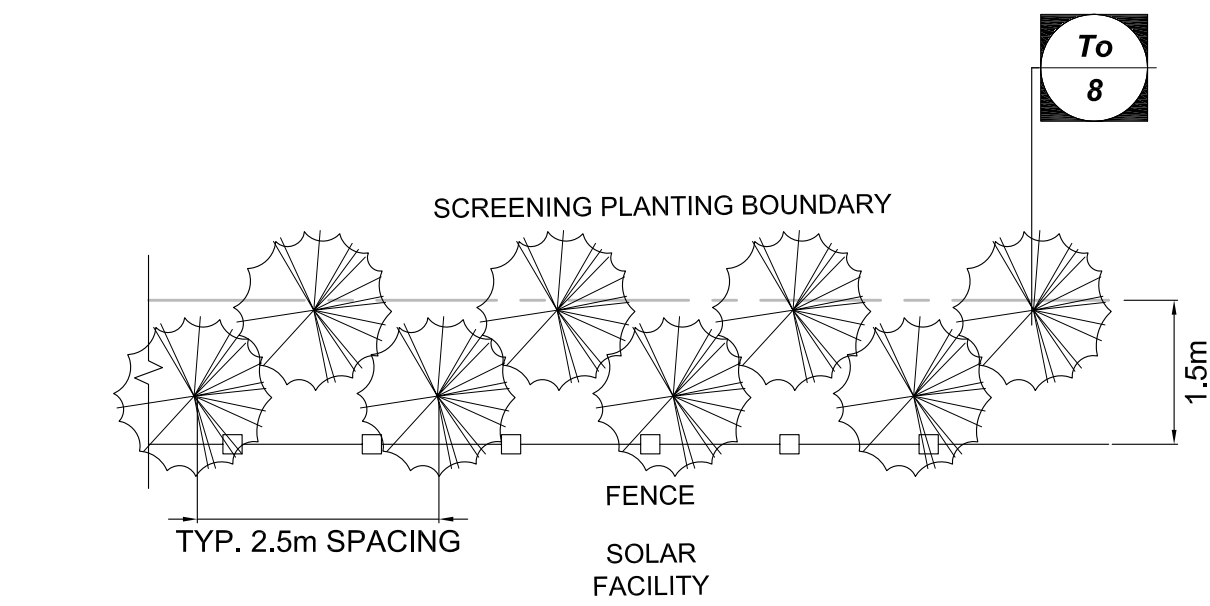

D5 SCREENING LANDSCAPE A
N.T.S.

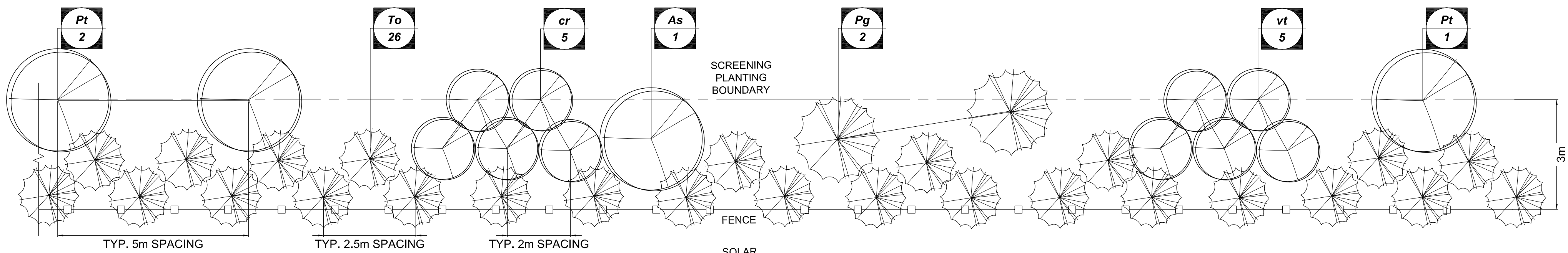

D6 ENHANCED SCREENING LANDSCAPE B
N.T.S.

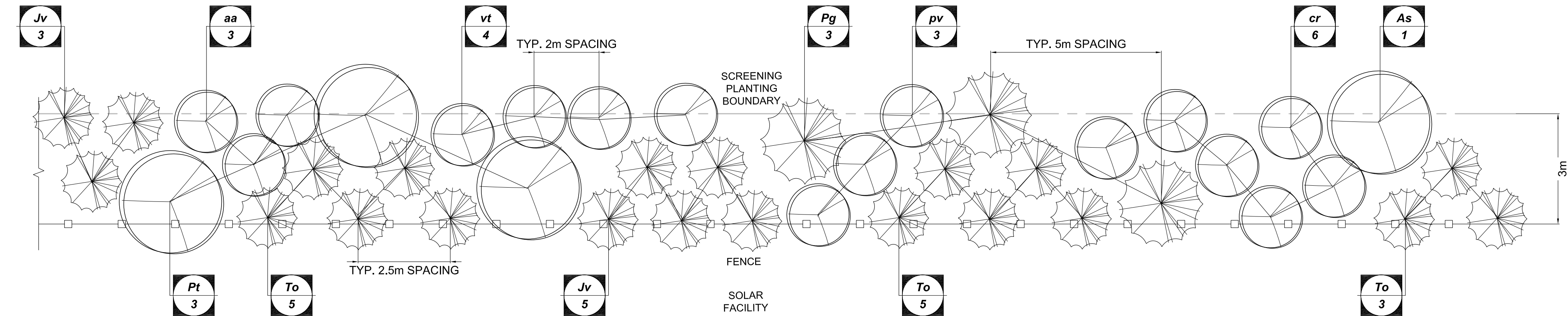

D7 ENHANCED SCREENING LANDSCAPE C
N.T.S.

TYPICAL PLANTING NOTES:

1. NO SPECIES SUBSTITUTION WITHOUT WRITTEN AUTHORIZATION FROM THE LANDSCAPE ARCHITECT.
2. ENSURE THAT PLANT MATERIAL DOES NOT DRY OUT PRIOR TO INSTALLATION.
3. TREES SHALL BE SET @ 50mm ABOVE ORIGINAL NURSERY GRADE AND SURROUNDING GRADE TO ALLOW FOR SETTLEMENT.
4. DO NOT ALLOW AIR POCKETS WHEN BACKFILLING.
5. MULCH AND WATER PLANT IMMEDIATELY FOLLOWING PLANTING.
6. CONTRACTOR SHALL REMOVE TREE STAKES AND TIES ONE YEAR AFTER PLANTING, OR AT END OF WARRANTY PERIOD IF STAKES ARE STILL REQUIRED.
7. NO TREE PITS SHALL BE LEFT OPEN OVERNIGHT.
8. PLANT MATERIAL SHALL NOT SIT ON SITE FOR LONGER THAN 5 DAYS.
9. DISTURBED SOIL AREAS TO BE SEEDED WITH SPECIFIED SEED MIX. CONTRACTOR TO USE 100% ELYMUS CANADENSIS (CANADA WILD RYE) AS A COVER CROP. SEEDING TO BE IN ACCORDANCE WITH OPSS 572.
10. TOPSOIL TO BE SUPPLIED AND INSTALLED ACCORDING TO OPSS 570 TO A MINIMUM DEPTH OF 150mm UNLESS OTHERWISE SPECIFIED.
11. DISTURBED SOIL AREAS TO BE COVERED WITH MINIMUM 75mm SHREDDED MULCH SUCH AS GRO-BARK SPM OR HARDWOOD BLEND OR APPROVED EQUIVALENT. ALTERNATIVE MULCH TO BE APPROVED BY LANDSCAPE ARCHITECT IN WRITING.
12. PLANTING ON 3:1 SLOPE, CREATE TEMPORARY 100MM HIGH SOIL MIX BERM ON DOWNHILL SIDE OF PLANTING PIT TO RETAIN WATER. ENSURE THAT PLANT MATERIAL DOES NOT DRY OUT PRIOR TO INSTALLATION.

TYPICAL NOTES:

1. ALL WORK TO BE CARRIED OUT IN ACCORDANCE WITH BY-LAWS AND CODES HAVING JURISDICTION OVER SITE LOCATION.
2. THE CONTRACTOR SHALL MAKE EVERY EFFORT TO PRESERVE MATURE TREES WHICH ARE BEYOND THE CONSTRUCTION LIMITS.
3. ANY CHANGES OR SUBSTITUTIONS TO THE PLANT MATERIAL MUST BE APPROVED BY THE LANDSCAPE ARCHITECT.
4. CLEARING AND GRUBBING SHALL BE UNDERTAKEN AS TO MINIMIZE DISRUPTION TO ADJACENT LANDS NOT WITHIN THE CONSTRUCTION LIMITS. ENCROACHMENT ON WOODLANDS NOT INDICATED ON THE DRAWINGS WILL REQUIRE WRITTEN CONSENT BY THE LAND OWNER AND CONSERVATION AUTHORITY.
5. IT IS THE RESPONSIBILITY OF THE CLIENT AND THEIR SELECTED CONTRACTOR TO CONFIRM THE ACCURACY OF THE SETBACKS, LOCATIONS AND GRADES, ETC. ANY VARIATIONS BETWEEN EXISTING CONDITIONS AND THE PLAN SHOULD BE ADJUSTED ON SITE AND REPORTED TO THE LANDSCAPE CONSULTANT TO DETERMINE THE IMPACT OF THE VARIATIONS ON THE STABILITY OF THE PROPOSED PLANTING.
6. IT IS THE RESPONSIBILITY OF THE CLIENT AND THEIR SELECTED CONTRACTOR TO CONFIRM THE LOCATIONS OF ALL UTILITIES, BOTH ABOVE AND BELOW GROUND. ANY UTILITIES ON SITE FOUND TO CONFLICT WITH THE PLAN SHOULD BE REPORTED TO THE LANDSCAPE CONSULTANT TO DETERMINE WHERE ADJUSTMENTS TO THE PLANTINGS ARE REQUIRED.
7. CONTRACTOR TO PROVIDE A MINIMUM TWO (2) YEAR WARRANTY FROM DATE ACCEPTED ON ALL WORK.
8. CONTRACTORS ARE NOT TO SCALE MEASUREMENTS OFF OF THE DRAWING.
9. LANDSCAPE PLAN IS DRAFT UNTIL APPROVED BY THE LOCAL MUNICIPALITY.

DRAFT
NOT FOR CONSTRUCTION

Conditions of Use

Verify elevations and/or dimensions on drawing prior to use.
Report any discrepancies to Dillon Consulting Limited.

Do not scale dimensions from drawing.

Do not modify drawing, re-use it, or use it for purposes other than those intended at the time of its preparation without prior written permission from Dillon Consulting Limited.



DESIGN	JL	REVIEWED BY	CP
DRAWN	JL	CHECKED BY	CP
DATE	June 2015		
SCALE	NTS		
1	Submitted to Client for Review	06-11-15	JL
No.	ISSUED FOR	DATE	BY

SOUTHGATE SOLAR LP

PROJECT NO.
14-9154

LANDSCAPE SCREENING
PLANTING DETAILS

SHEET NO.
L9

